



90010087 | 1/16" 10-32 brass barb



90010088 | 1/8" 10-32 brass barb



P1054 | brass hex plug 10-32



P1055 | nylon washer 10-32

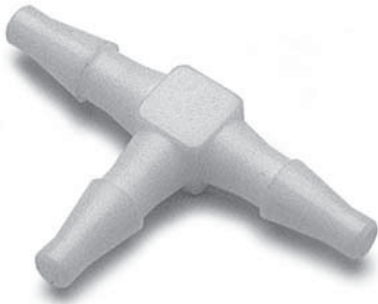

P1056	plastic tee 1/16"
P1057	plastic tee 1/8"



P1058	plastic inter connector 1/16"
P1059	plastic inter connector 1/8"
P1761	plastic inter connector 1/8"x 1/16"



P1850	plastic "Y" connector 1/16"
P1852	plastic "Y" connector 1/18"



P1854	plastic elbow 1/16"
P1856	plastic elbow 1/8"

- 1/16" or 1/8" x 10-32



P1875 | 1/16" plated brass tee

P1876 | 1/8" tee

- Plated Brass

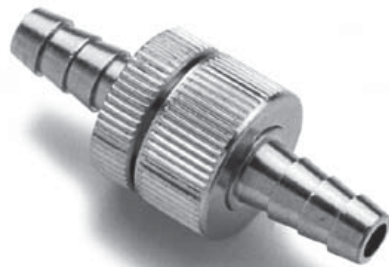

P1877 | mini quick disconnects 1/16"

P1878 | mini quick disconnects 1/8"

- Plated Brass



P1062 | tubing collar 1/4"

92020000 | tubing collar 1/8"



P1076 | 1/16" x 1/8" 10-32 stepped barb

- Plated brass
- Allows hookup flexibility
- Use for portable equipment hookup fitting



P1686 | plated brass barb 1/16" x 1/16"

P1687 | plated brass barb 1/8" x 1/8"

P1688 | plated brass barb 1/8" x 1/16"

- Plated Brass



P1760 | plastic tee 1/16" x 1/8" x 1/16"

P1762 | plastic tee 1/8" x 1/16" x 1/8"

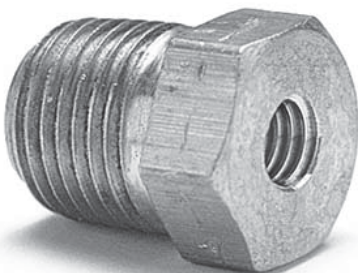

P1770 | adaptor connector

- 1-8 X 10-32



P1815 | brass cross

- 10-32 Female ports
- Plated



P1820 | brass tee

- 10-32 Female ports
- Plated

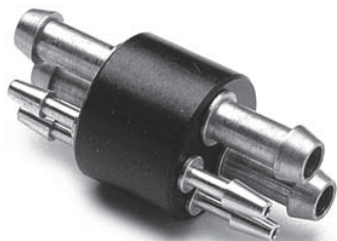

P1825 | 4 hole tubing connector

- Handy for extending HP or Foot Control Tubing
- Plastic body with brass barbs